

Blue Evolution Plus+ Steam Cleaning and Disinfection System with Vacuum and UV-C
User Manual



Congratulations! And thank you for purchasing the Blue Evolution Plus+ Steam Cleaning and Vacuum System with UV-C and HEPA from Intersteam Technologies.

This manual contains detailed instructions for the operation of your steam cleaning system, including cleaning procedures, safety instructions and warranty and return policies.

Your machine is engineered with technology and power to tackle the toughest cleaning jobs in an easy and chemical free way. You can use your system to effectively clean and sanitize virtually any surface.

Cleaning with your Blue Evolution System means:

- *Removal of all debris and biofilms with powerful extraction
- *Fast and effective cleaning
- *Thorough and economical cleaning
- *Highest levels of sanitation available from any system available

Using Steam Vapour:

- *Disinfects
- *Destroys bacteria
- *Neutralizes odours
- *Is environmentally friendly

Please read this manual thoroughly and carefully. It provides important information for the safe set-up, use and maintenance of your system

If you need further information after reading this book, feel free to contact us.



Phone 905-526-1453 or 1-800-281-4413
elle@intersteam.com www.intersteam.com

SAFETY INSTRUCTIONS FOR USING A STEAM VAPOUR SYSTEM

The Steam Vapour System is an electrical appliance used to generate high temperature, low moisture steam vapour which is easy to use. The system is designed to be used for sanitation and cleaning a wide variety of surface types using the heat contained within the steam vapour as the functional agent. As such, the user is required to read and understand the instructions for use as set forth in this manual, to follow accepted safety practices as with any other electrical appliance, and to read and understand the following:

1. Before connecting the machine, check that the data on the voltage rating plate are the same as the power supply. The rating plate is found on the bottom of the unit.
2. The packaging materials (box/plastic) must be kept out of the reach of children.
3. Never direct the steam ports at any body parts, person or animal, as hot steam can cause injury.
4. Never use the system for anything other than its intended use, or use attachments not recommended by the manufacturer.
5. Never use a system that is not connected to a properly grounded electrical outlet of 120 VAC, 60/50 Hertz (cps), or if the power cord is damaged in any way. Protect the power cord from rubbing against sharp objects, catching between doors and drawers or being exposed to heat, steam or oil. Always ensure the cord is in good shape prior to plugging in the unit. Any required repairs to the power cord should only be performed by Intersteam Technologies or an authorized service centre.
6. Never use a system in a wet environment, or subject the system to extreme heat or cold, or use in an area where volatile fumes may be present or immerse in any type of liquid.
7. Never attempt to continue to use a damaged or malfunctioning system. Turn "off", then unplug the system and return it to your nearest authorized service facility.
8. Never use extension cord of less than 14 gauge in size (AWG), or rated less than 15 amps, or without a proper ground connection or safety listings, or in excess of 50 feet in length. All extension cords should have safety markings (CSA/NRTL).
9. Never use the power cord or steam hose as a handle to pull or carry the system.
10. Never leave the system unattended, even for short periods, when turned "on" or plugged in to an electrical outlet.
11. Never direct steam into electrical sockets, electrical switches, or use on electronic equipment even if unplugged as steam may cause damage leading to electrical shock.
12. Never turn the unit upside down or on its side, especially when switched on.

13. Never put anything into the machine reservoir except clean, clear, potable water, as damage may occur to the system, and may put the user at risk of illness or injury; adding materials other than water will also void the warranty.
14. Never store the system where it may be exposed to severe temperature fluctuations, weather conditions or personnel traffic.
15. Always test the surface to be cleaned, as to whether high temperature of the steam will deform or damage the surface, in an inconspicuous area, particularly if the surface may be susceptible to damage from heat or moisture.
16. Always turn steam flow “off” before changing tools, accessories, brushes or bonnet towels. Steam vapour is hot and can cause burns. Ensure that the accessories are properly attached before turning “on” the steam.
17. Always use caution in removing brushes or bonnet towels from tools, as they can be hot enough to cause scalding.
18. Always turn the power switch to the “off” position before unplugging the cord from the electrical socket to reduce danger of electrical shock. Never pull the power cord or the steamer to unplug the machine.
19. Always make sure the unit is unplugged and completely cold before performing the drain procedure.

Be sure that you understand and use these rules for safe and effective operation of your Steam Vapour System. This appliance must only be used for the purpose for which it was designed: a steam generator with cleaning accessories. The manufacturer or distributor may not be held liable for any damage arising from the improper, incorrect or unreasonable use of the system. We recommend that you keep this manual handy for future reference.

WARNING – this appliance contains a UV emitter. Do not look directly into the source of light. Do not switch on the UV light if it is outside the appliance’s protective housing. The appliance may emit harmful UV-C radiation if not used properly. Even small doses of UV-C radiation may cause damage to eyes and skin.

Machine Description – Components and Accessories

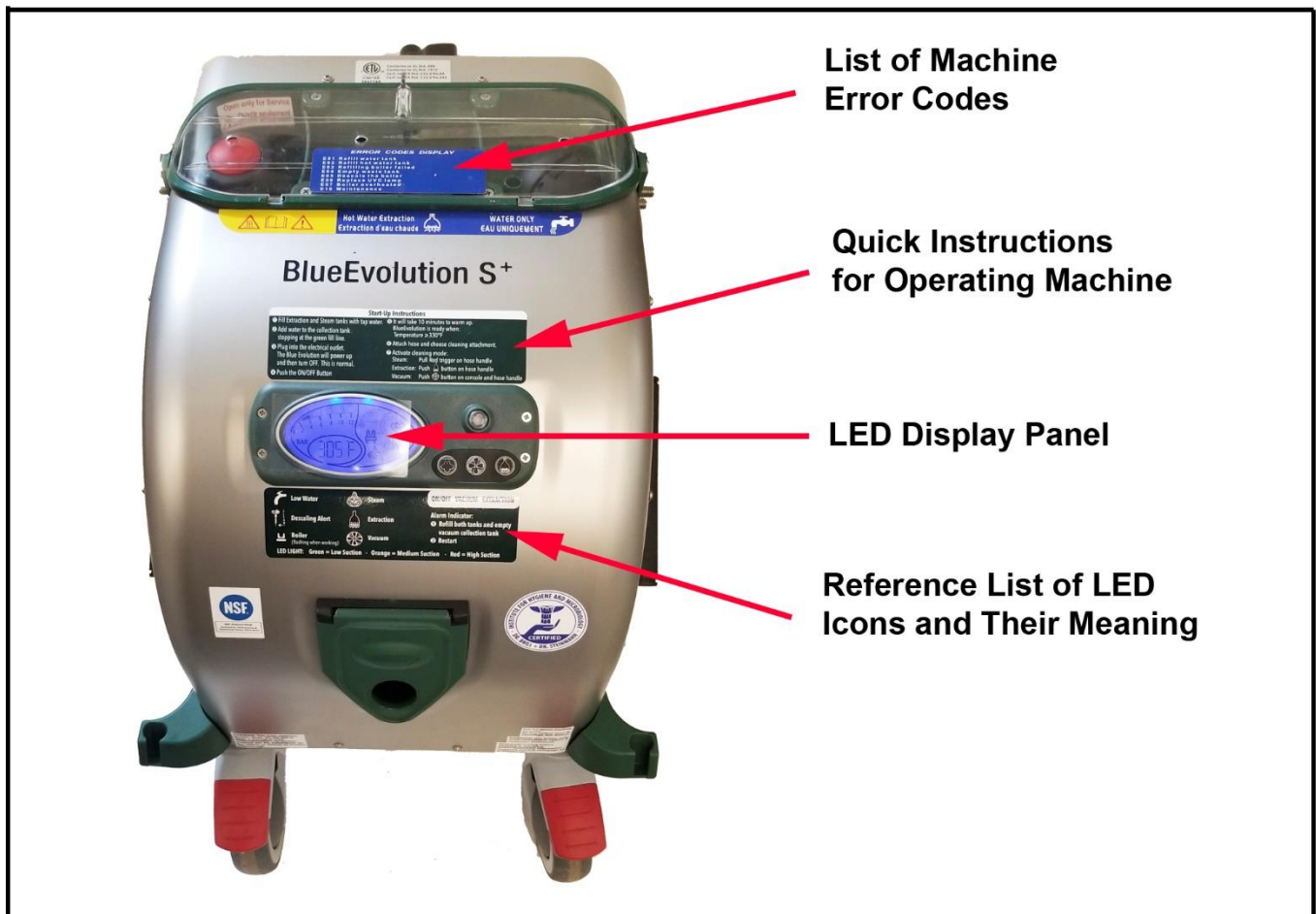



List of Machine Error Codes

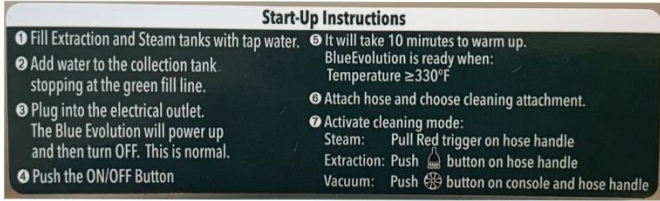

Quick Instructions for Operating Machine



LED Display Panel

Reference List of LED Icons and Their Meaning

1. Hose



2. Extension Tubes



3. Lance Nozzle



4. Floor Brush



5. Standard Nozzle
6. Multi-Jet Nozzle



7. Nozzle Brushes



8. Vacuum Adaptors for Nozzles



9. Large Steam and Vacuum Tool with 3 Cleaning Adaptors



10. Small Steam and Vacuum Tool with 3 Cleaning Adaptors



Accessory Chart



Hose



Extension Tubes



Floor Brush



Standard Nozzle



3-Jet Nozzle



Vacuum Suction Adaptors



Nozzle Brush

Used for
Detail
Cleaning



Large Steam and Extraction Tool

No Brush

→ Carpet, Upholstery and Mattress



→ Glass, Stainless Steel, Mirrors



→ Windows



→ Textured surface



Small Steam and Extraction Tool

No Brush

→ Carpet, Upholstery and Mattress



→ Glass, Stainless Steel, Mirrors



→ Windows



→ Textured surface. Soiled upholstery

Warranty

This warranty applies to all Blue Evolution Steam Cleaning Systems.

The Vapour Cleaning System is warranted free from defects in workmanship and material on purchase as follows:

Boiler.....	3 Years
Steam Cleaner.....	1 Year
Accessories (Except Brushes and Nozzles).....	6 months
Plus+ Equipped Boiler.....	6 Years
Plus+ Equipped Steam Cleaner.....	2 Years

If the goods are defective, Intersteam Technologies will repair or replace, at the vendor's options without charge on return to the Vendor's service centre.

Intersteam Technologies will not assume responsibility or warranty work arising from the lack of routine maintenance, from misuse or abuse of the Vapour Cleaning System, or from any accident in which the Vapour Cleaning System may be involved.

This warranty is only given to the original purchaser of the goods and is void if the goods have been used other than for the purpose for which they are intended to be used, or not used in accordance with the operating instructions supplied.

This warranty is void if the Vapour Cleaning System has been adapted or repaired other than by the vendor or an approved service centre. It is also void if the Vapour Cleaning System is added on to or used with other goods which may affect the integrity, performance, safety or reliability of the Vapour Cleaning System.

Intersteam Technologies reserves the right to replace defective parts only, according to its warranty if upon examination, such parts prove to be defective.

The warranty will be honoured upon satisfactory proof of purchase and proof of date of purchase.

Supplemental Warranty Information

Limited Warranty (Canada)

Your product has been manufactured, tested and inspected in accordance with carefully specified engineering requirements and is warranted to be free from defects in material and workmanship in accordance with the terms and conditions set forth below.

Duration of Warranty and To Whom Extended

This Limited Warranty for the system shall be as follow from the date of purchase by the original purchaser, three years on the boiler and on year on all other parts. Plus+ Module doubles this warranty, when purchased with the system at time of original purchase.

Exceptions and Exclusions from Warranty

This product incorporates a boiler powered by electricity and is to be used with the electrical current as indicated on the rating plate. This Limited Warranty does not apply to product which has been subject to use on electrical current other than indicated on the rating plate. This Limited Warranty does not apply to product that has been subject to improper, unreasonable or negligent use, abuse or the use of parts or accessories which are not approved by the manufacturer. If repair is done on your equipment by anyone other than those authorized to perform such work, the manufacturer, at its sole option, may determine that the Limited Warranty will not apply and reimbursement for repair will not be made.

Procedure to be Taken to Obtain Performance of Warranty

To secure repair or replacement of parts under this Limited Warranty, the following procedure shall be taken. The inoperative product/parts, together with satisfactory evidence of purchase date, must be delivered with shipping and delivery prepaid to one of the following:

1. The dealer from whom purchased.
2. Intersteam Technologies

Upon compliance with the above, all warranted defects will be repaired or replaced, at no additional charge or cost to the customer, and the subject product shall be returned to the customer with shipping and Delivery charges prepaid.

INTERSTEAM TECHNOLOGIES DISCLAIMS ALL LIABILITIES FOR ANY CONSEQUENTIAL OR INCIDENTAL DAMAGES THAT MAY BE INCURRED IN CONNECTION WITH YOUR PURCHASE, USE OR INABILITY TO USE THIS PRODUCT. INTERSTEAM TECHNOLOGIES MAXIMUM LIABILITY IN ANY EVENT SHALL NOT EXCEED THE PURCHASE PRICE PAID BY THE ORIGINAL PURCHASER. THIS EXPRESS WARRANTY IS THE SOLE WARRANTY OF INTERSTEAM TECHNOLOGIES AND IS IN LIEU OF ALL OTHER WARRANTIES, EXPRESS OR IMPLIED, INCLUDING MERCHANTABILITY OR FITNESS FOR A PARTICULAR PURPOSE.

Return Policy

This policy covers all Steam Cleaning Systems, Carts and Accessories.

If you are not satisfied with the performance of your steam cleaning system within one week of date of purchase, we will gladly offer a refund, less a 15% restocking fee. Normal use of accessories is included; however any unreturned accessories will be added to the restocking fee at full price.

Any returned items must be sent to Intersteam Technologies, or to the authorized dealer from which they were purchased. Please consult your independent dealer for their terms and conditions. Intersteam Technologies may not accept returned systems purchased through a reseller.

Please package all items in original packaging. This will help to minimize any potential shipping damage. Ensure all accessories are included. Please drain all water from the machine tank and boiler.

You are responsible for the shipping costs for shipping the machine both ways. Unless you provided a shipping account number, you will have been invoiced for the original shipping cost.

You will be reimbursed the original purchase price of the system, less restocking fees (including missing accessories or unnatural equipment abuse or damage), plus taxes paid. Refunds will be issued in the manner in which the invoice was paid. If the invoice is unpaid, a credit memo and statement will be sent, at which time prompt payment is expected.

SteamKing 1500 Systems and White Utility Carts should be returned in their original packaging. An additional 5% will be added for units not returned in this manner.

General Operating Procedure

Pre-Operation

- Remove the reservoir cap and fill the WATER ONLY tank with potable water. Remove the middle reservoir cap and fill the HOT WATER EXTRACTION tank with your choice of water or diluted detergent (non acid, low foaming).
- Use only potable water to fill WATER ONLY reservoir. **Never put soap or any other chemical in the WATER ONLY reservoir tank, doing so will void your warranty.**



- Replace caps when tanks have been filled.
- Ensure wastewater collection tank is clean and add water to the green fill line.



- Ensure that either the power cord on the unit or the extension cord you are using is plugged into a properly working 120V grounded outlet. If you must use an extension cord, always use a 14-3 AWG cord rated for 15 Amps. Please keep the extension cord supplied with your system designated for its use only. If you must extend a power cord longer than 50 feet, use a 12-3 AWG cord.
- Turn the machine on using the left button on the control panel.

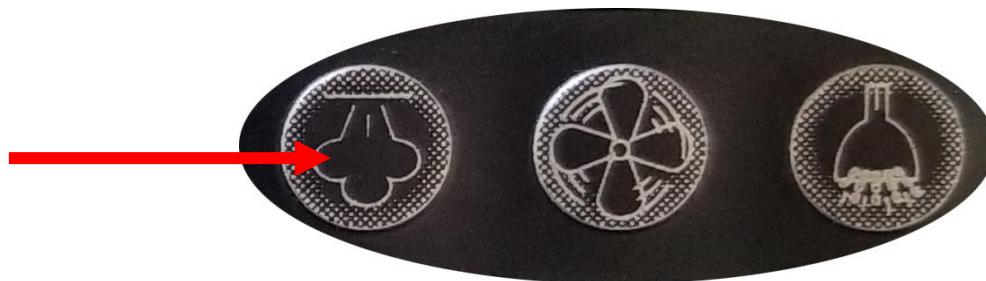

- The machine is ready when the boiler temperature reads 339 deg F. The steamer will take 5-7 minutes to heat.

Indicator Panel

- All messages regarding filling, heating and operating your machine will display on the digital panel. You will find the pressure, temperature, steam and vacuum settings, error codes and any other notifications displayed here.



Steam Hose

- Lift the hose socket cover and fit in the steam hose attachment. You will hear a click. When connected properly the electronic controls on the handle will have 12V of power. DO NOT use on the high setting for periods longer than 10 minutes.
- Once the hose is connected to the machine, supply power to the vacuum by pressing the middle button on the control panel.
- All accessories (except nozzle brushes) may be used directly on the steam hose.

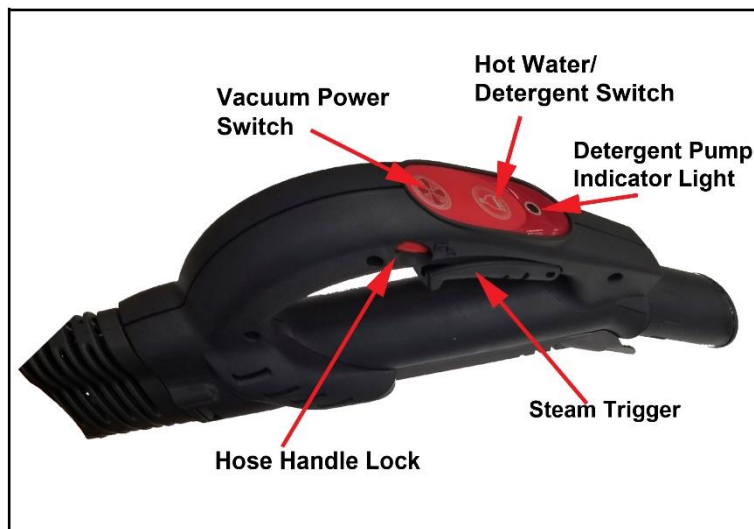
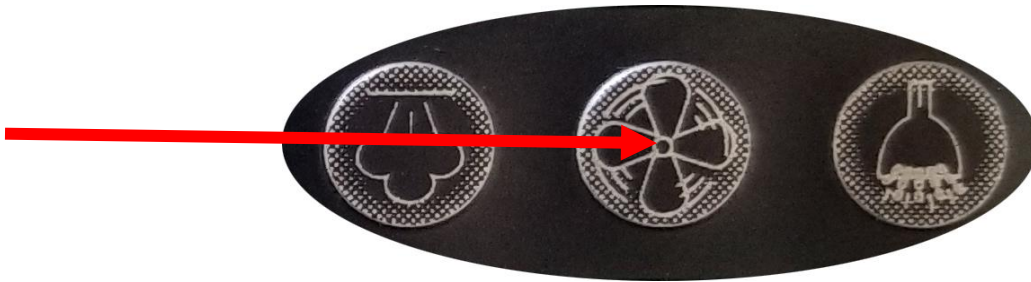



IMPORTANT NOTE:

DO NOT PULL THE STEAM GENERATOR AROUND BY OR TUG ON THE STEAM HOSE.

IT IS THE HEAT OF THE STEAM DOING THE WORK FOR YOU. THE HEAT IS THE SAME ON LOW, MEDIUM OR HIGH SETTING. THE DIFFERENCE IS HOW FAR THE HEAT IS PUSHED OUT AND THE MOISTURE CONTENT OF THE STEAM.

Option Selection

- On the hose handle you can choose to add water/detergent from the middle reservoir tank with the steam. Do so by pressing the  button on the hose handle. The light next to the button will light up when this function is in use.
- Turn the vacuum off and on as required using the  button on the hose handle.
- Steam is dispensed using the trigger on the hose handle.

End of Operation

- Turn off power to machine.
- Unplug unit from electrical source.
- Store in a warm place, out of traffic.

Important Notes

1. The wastewater collection tank must have the lid in place during operation to allow the machine to sense that it is in place.
2. If the wastewater collection tank becomes too full of debris/sludge or foam, the sensor will indicate that it is full (regardless of if it is). You will need to empty and clean the tank if this occurs.
3. The vacuum system uses water to filter the extracted dirt. You must fill the tank to the green line prior to use with clean water.
4. The HEPA filter can be cleaned and replaced as needed. To do so, remove the exhaust cover on the underside of the machine by removing the centre bolt
5. You can clean the filter with an air hose or order a replacement part as needed.



Maintenance

Heating water will cause scale build up in the boiler of the machine. You should drain your system after every 10 uses. You will need to remove the cover from the bottom of the machine using the large bolt. You can then access 3 drain plugs – one for the boiler which **MUST NEVER BE TOUCHED** when the machine is hot, one for draining water/detergent from the middle reservoir and one for removing water from the **WATER ONLY** reservoir. Remove the boiler drain plug and allow the water to empty into a bin, sink or drain. Once the boiler is empty, refit the drain plug, ensuring that the o-ring is in good shape. You can then continue using your machine right away.

Boiler Tank Drain Plug (13mm)

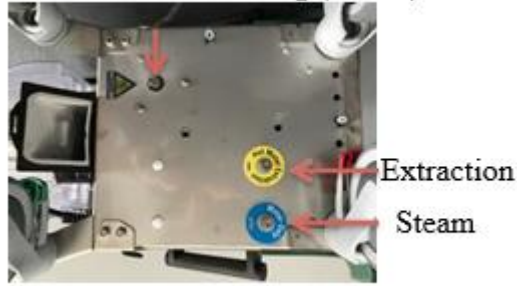

You need to drain the water/detergent tank when changing the contents of the reservoir. If you intend to use a different detergent than is currently in the tank, you must empty and flush the tank. If you wish to add a detergent when the tank is full of water, you must empty the tank. If you intend to store your machine for a prolonged period of time, it is recommended to remove detergent from the tank.

If you suspect that detergent or debris have been introduced into the **WATER ONLY** tank, you should empty that tank.

You will need to clean and refit the probe sensor when the indicator light on the display panel is lit. It is the image pictured here found on the right side of the LED panel – filled in solid black in colour. You can remove scale from the probe sensor using vinegar or a scouring pad or in extreme cases, a very fine grit sandpaper. You must ensure **ALL** debris is wiped from the probe and it is exceptionally clean before replacing it into the boiler.



You should clean accessories, brushes and hose after each use. You can rinse the hose by sucking clean water through it. You can remove the insert in the wastewater collection tank to ensure thorough cleaning

You should replace o-rings every year, or at signs of damage.

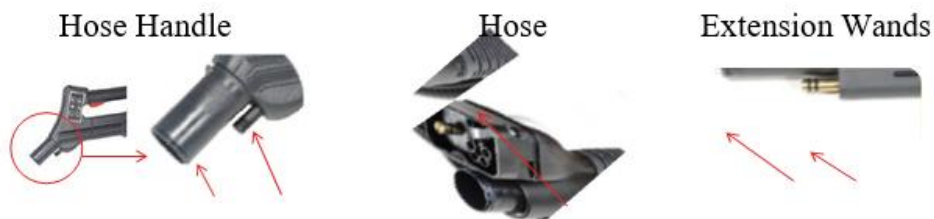

Troubleshooting

PROBLEM	SOLUTION	
The Blue Evolution does not turn on.	<ul style="list-style-type: none"> ➤ The Blue Evolution should be the ONLY appliance plugged into the electrical outlet. ➤ Check the fuse box for tripped circuit breaker. ➤ If using an extension cord it must meet the following requirements: <ul style="list-style-type: none"> ➤ <i>Use only a 12 gauge / 15AMP rated or higher extension cord.</i> ➤ 25 ft. max length 	
The Blue Evolution powers ON after plugging into the electrical outlet and then turns OFF.	<ul style="list-style-type: none"> ➤ This is normal. ➤ Push the ON/OFF Button on the console to power ON the Blue Evolution. 	
During the warm-up phase the Blue Evolution's alarm goes off.	<ul style="list-style-type: none"> ➤ The boiler pulled all the water from the steam reservoir tank ➤ Refill the steam reservoir tank ➤ Push the ON/OFF button on the console to reset. 	
No Vacuum Suction Warning alarm goes off	<ul style="list-style-type: none"> ➤ Empty and clean the collection tank. ➤ Refill with water to the green fill line. 	
No Vacuum Suction No warning signals	<ul style="list-style-type: none"> ➤ Collection tank lid is not attached correctly. <ul style="list-style-type: none"> ➤ Lid must sit flush on the and locked into position. ➤ It's helpful to attach the lid to the tank before installing. ➤ Check hose for foreign objects or dirt. ➤ Check and replace the HEPA filter as needed. 	
Error Codes Will show on console screen	01 – Refill Steam tank 02 – Refill Extraction tank 03 – Boiler did not refill 04 – Collection tank is full 05 - Descale boiler	06 – Replace UVC lamp 07 - High steam temperature 08 - Replace anti-scaling filter 09 – High motor temperature 10 – Service required

Technical Data

Technical Data			
Steam Max pressure	117 PSI	Voltage	120V 60Hz
Boiler Max temperature	338°F	AMPS:	13.5
Dimensions (in)	15 x 28 x 37 (W x L x H)	Maximum power	1800W
Shipping Weight	98 pounds	Max Boiler Powder	1000 + 700W
Power cord Length	10 ft.	AISI 304 stainless steel boiler	
Hose Length	10 ft.	Vacuum motor power	1200W max
Tank Capacities		Vacuum Water Lift	83 inches
Steam reservoir tank:	½ gal	Vacuum Air flow	47CFM
Extraction reservoir tank:	½ gal		
Vacuum collection tank	.8 gal		

This system is fully CSA Approved.

Disclaimer

These instructions contain information needed for the correct use, safe handling and correct maintenance of the Blue Evolution Cleaning System. Familiarization with and observance of these instructions lead to the safe and proper use of this machine. These instructions cannot cover all possible uses of the system. For any further information please contact Intersteam Technologies. All legal obligations of Intersteam Technologies are based on the terms of sale which also contains the full and exclusive terms and conditions of the warranty. These instructions do not limit or extend the conditions of the warranty. The instructions contain information protected by copyright and may not be reproduced in any way or translated into any other language without the prior written authorization of Intersteam Technologies.

If I Need Help, What Do I Do?

We are pleased to provide exceptional warranty and service capabilities to our customers.

We are extremely efficient, factory trained, and dedicated to doing service on steam cleaning systems, so we are good at it, fast, and we keep all necessary parts in stock.

We have customers across Canada and into the U.S. and we are able to service them all. We deal with a repair immediately when it comes in, and usually complete it same day. Use of couriers speeds the process, at a reasonable cost.

If your machine is not working properly - not turning on, not heating up, not building pressure or ejecting steam at points other than the end of the hose - you may need to send it to us for repair.

PLEASE NOTE - There should NEVER be any chemical used in the WATER ONLY reservoir. Tap Water is the ONLY thing that you should put in the WATER ONLY reservoir. Chemicals are not meant to be boiled. The end result is usually a toxic sludge that presents health concerns, damages components in your machine and VOIDS your Warranty.

THE MOST IMPORTANT THING you can do to prolong the life of your system and maximize its performance is to regularly perform the Drain Procedure.

When you send us your machine you usually need only send the base unit. If you are unsure of what to send - Just ask.

STEP ONE: Please drain the machine. The reservoir (at the top of the unit where you add water) and the Boiler (at the bottom where you perform the drain procedure) should be emptied.

STEP TWO: Please package your machine well. The actual rule of thumb for most couriers is that the package should remain intact after a 4-foot drop. Unnecessary repair issues can occur from broken upper and lower housings, castors and shaken components inside the machine.

STEP THREE: Please call 800-281-4413 to arrange a return shipping waybill.

Then simply call the courier to pick your shipment up.

When we receive the unit, we will inspect it, prepare an estimate and call you. We will never spend a dime of your money without your permission. We normally inspect the units the day they are received. We will then call you - so please provide your contact information with your machine unless you have called to arrange your service ahead of time. We typically perform the service within a day of receiving your permission and courier your unit back to you - good as new.

If you have questions about our service department, policies or procedure, please call 1-800-281-4413 or email sean@intersteam.com



1-800-281-4413 www.intersteam.com